

SUPER OIL COOLER KIT		
SUPER OIL COOLER KIT for NSF100		No.1/2
CODE	(With ultra clutch cover)	360-1418210
	(Without clutch cover)	360-1418700
APPLICATION	NSF100	

● Thank you for purchasing Kitaco product. Read and understand the instruction before installing.

ATTENTION (MUST READ)

- It is to cool engine oil to avoid heating troubles to cause performance decrement.
- We are not responsible for violation of law or damages and accidents caused by assembling mistake and improper setting.
- Follow this instruction sheet. Do not modify the way which is not listed or it will cause damage and trouble.
- Please ask authorized mechanic for assembling and setting.
- Refer to the manufacturer service manual when installation.
- Bolts and nuts may get loosen by engine vibration.
- This product is designed and made exclusive for application models, do not use other models.



FLAMMABLES
Inflammable high oil is used during operation. Using products causing fire or smoke is strictly prohibited.

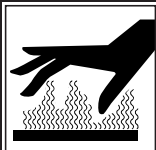

Engine oil is very hot during and after engine operation, so start work when the engine oil is cool enough (oil is hot even if the surface is cool).

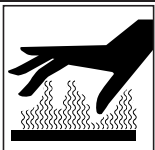

Cylinders, crankcases, mufflers, etc. are very hot during and after engine operation and should not be touched carelessly.



This instruction sheet is for the person who has basic knowledge for maintenance. Do not operate if you do not have skill and knowledge.

130718 K-Y

<https://www.kitaco.co.jp/>



		KIT contents		
Fig	NAME	CODE	360-1418210	360-1418700
A1	R-CRANKCASE COVER	307-1122210	× 1	
A2	OIL SEAL (18 × 29 × 7)	333-1122013	× 1	
A3	OIL LEVEL GAUGE (φ20)	307-1083006	× 1	
A4	COTTER PIN (2.0 × 15)	995-0801020	× 1	
A5	M6 × 18 BUTTON CAP BOLT	060-0550015	× 2	
A6	OIL FILTER COVER	390-1122704	× 1	
A7	O RING (2.6 × 38.6)	390-1083705	× 1	
A8	OIL ELEMENT	390-1083701	× 1	
A9	OIL FILTER SPRING	390-1083703	× 1	
A10	R-CRANKCASE COVER GASKET	966-1122000	× 1	
A11	PLUG (APE100)	307-1122211	× 1	※NOT REUSABLE
A12	M6 × 90 FLANGE BOLT	062-0560090	× 1	
B1	S OIL COOLER CONDENSER (5-LAYER)	360-0500200	× 1	× 1
B2	UNION BOLT (RED)	771-0900900	× 2	× 2
B3	UNION NIPPLE (BULE)	990-0900900	× 2	× 4
B4	OIL NIPPLE (BULE)	990-0900800	× 2	
B5	ALUMINUM BANJO/WASHER	771-0500999	× 6	× 8
B6	STAINLESS STEEL BAND (φ 10-16)	995-0500016	× 4	× 4
B7	OIL COOLER HOSE 100cm	991-0000100	× 1	× 1
C1	CONDENSER STAY	330-1418002	× 1	× 1
C2	M6 × 18 CAP BOLT	060-0500018	× 2	× 2
C3	WASHER (6.5 × 16 × 1.6)	090-0907006	× 4	× 4
C4	GROMEET (7.5 × 9 × 7.5)	752-9998099	× 2	× 2
C5	GROMEET COLLAR (6.2×7.5×7)	093-0900003	× 2	× 2
C6	CAP BOLT (U)6X35	060-0500035	× 2	× 2
C7	6mm WASHER	090-0900006	× 2	× 2
C8	6mm SPRING WASHER	091-0500006	× 2	× 2
C9	M6 NUT	001-0500006	× 2	× 2

■ MOUNTING

※KIT (331-1413000), sold separately, is recommended to prevent oil pressure drop due to installation of oil cooler.

- Cut the oil hose to the appropriate length after temporarily assembling the oil cooler. Route the oil hose so that it does not come in contact with the muffler or engine. Also, tie the hoses together with tie wraps, etc.
- Tighten the bolts and nuts to the torque indicated.
- Oil can be extracted from the ULTRA clutch case cover or our cylinder.
- Please add engine oil for the increase of the oil cooler (specified amount + 150cc additionally).

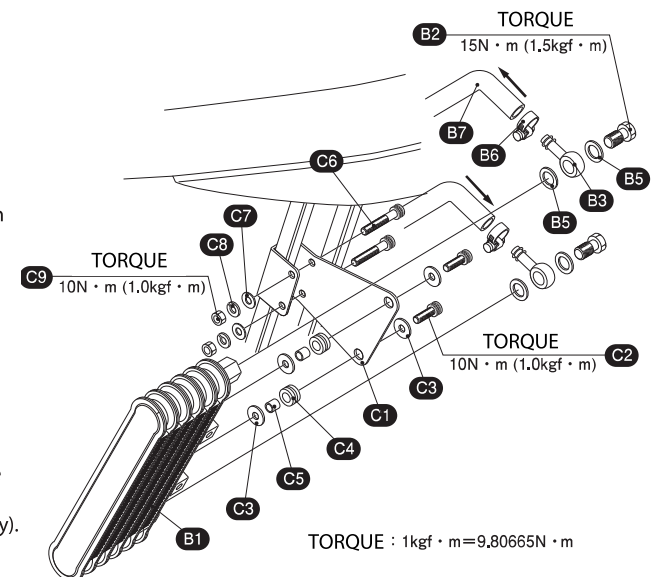

SUPER OIL COOLER KIT

SUPER OIL COOLER KIT for NSF100

No.2/2

CODE	(With ultra clutch cover)	360-1418210
	(Without clutch cover)	360-1418700
APPLICATION	NSF100	

STOCK PARTS (REUSED)

Fig.	NAME	QTY
N1	M6 × 100 BOLT	× 2
N2	M6 × 80 BOLT	× 4
N3	M6 × 40 BOLT	× 1
N4	M6 × 35 BOLT	× 1
N5	CLUTCH LEVER COMP	× 1
N6	O-RING 6.8 × 1.9	× 1
N7	CLUTCH LEVER SPRING	× 2
N8	CLUTCH LIFTER CAM	× 1
N9	M6 NUT	× 1
N10	6mm FLAT WASHER	× 1
N11	O-RING 6mm	× 1
N12	CLUTCH ADJUST SCREW COMP	× 1
N13	CLUTCH ADJUST REVER	× 1
N14	FILLER CAP	× 1
N15	O-RING 18 × 3	× 1
N16	KNOCK PIN 8 × 14	× 2
K1	UNION BOLT (BORE UP KIT INCLUDED)	× 2

TORQUE

NO	NAME	1kgf · m = 9.80665N · m
A5	M6 × 18 BUTTON CAP BOLT	10N · m(1.0kgf · m)
A12	M6 × 90 FLANGE BOLT	12N · m(1.2kgf · m)
B4	OIL NIPPLE (BLUE)	15N · m(1.5kgf · m)
N1	M6 × 100 BOLT	12N · m(1.2kgf · m)
N2	M6 × 80 BOLT	12N · m(1.2kgf · m)
N3	M6 × 40 BOLT	12N · m(1.2kgf · m)
N4	M6 × 35 BOLT	12N · m(1.2kgf · m)

CODE:360-1418700

When taking oil lines out of KITACO cylinders

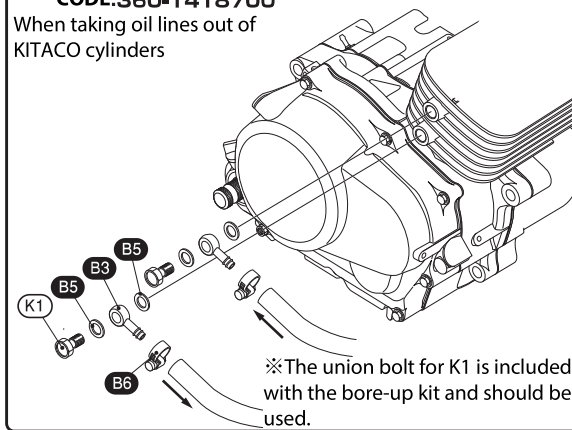

● For the removal and installation of this product (cover only), it is recommended to perform the task simultaneously with the disassembly of the upper engine parts. Removing and installing the cover alone is not ideal for the engine's structure, as it can cause distortion. Additionally, replacing the cover alone may lead to oil leakage from the crankcase mating surfaces.

- Parts not included with the product should generally be reused with the standard parts.
- If any reused parts show significant wear, damage, or deterioration, please replace them with new ones.
- Always lubricate each part with the engine oil to be used.

※ Only one oil hose is included. Cut it to the appropriate length for use. ※ The arrows in the diagram indicate the direction of oil flow.

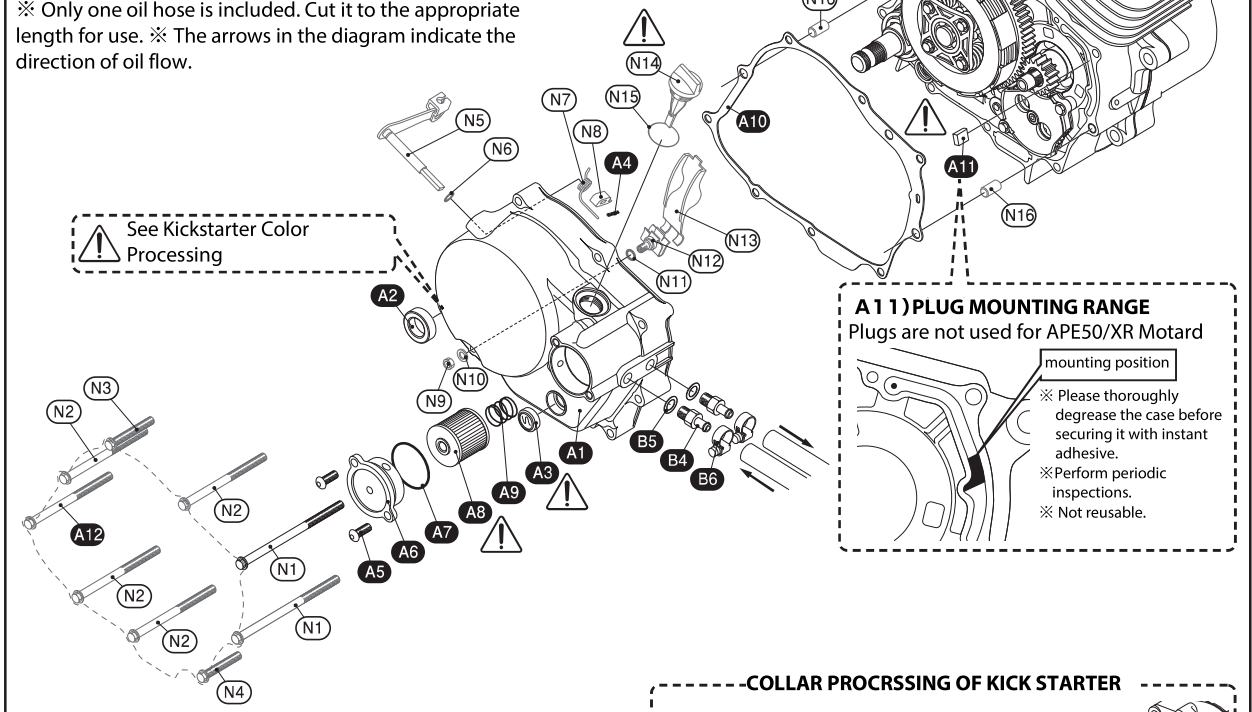

CAUTION&ADDITIONAL INFORMATION!

A3) How to read the oil level gauge
Stop the engine, wait 2-3 minutes, then level the vehicle and check the oil level. The total oil capacity differs from stock. Adjust by checking the oil level window, considering the presence of an oil cooler.

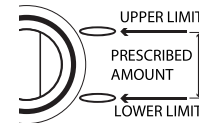

A8) Oil Element Replacement Time
Please replace the engine oil regularly at the rate of once every two engine oil changes.

N14) Machining of oil filler caps
Perform stock oil level gauge cutting process.

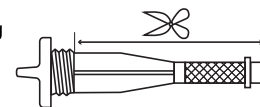

COLLAR PROCRSSING OF KICK STARTER

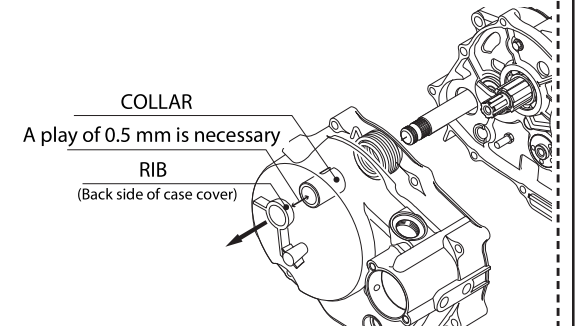

If there is no play between the ribs on the back side of the cover and the kick starter collar when the case cover is temporarily assembled, cut the collar to create a play of 0.5 mm width. If you assemble the case in such a condition, the case will be damaged.