



**SEROW250
COMES WITH VEHICLE SPECIFIC COUPLER HARNESS!
NO WIRING MODS REQUIRED!**

**LED SHUTTLE BEAM KIT
NEWLY RELEASED!!
SUPERIOR LED SHUTTLE BEAM POSITIONING!**

High luminosity LED beam lamp with vehicle specific stay and harness. High dress-up effect and visibility when driving at night.



LED SHUTTLE BEAM

- BODY : ALUMINUM DIE-CAST BLACK
- LENS : ACRYLIC
- DRIP-PROOF
- BRIGHTNESS : MAX : 800lm (CLEAR)
- COLOR TEMPERATURE : 6,000 K (CLEAR)
- POWER : 10W
- CURRENT : 0.9A



▲ NEW DESIGNED RIM LED SHUTTLE BEAM !

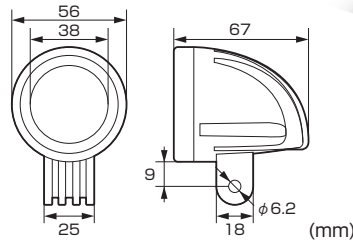

- ▲ POWER ON/OFF SWITCH
- TIGHTENS WITH BRAKE MASTER CYLINDER

LED SHUTTLE BEAM KIT



APPLICATION

SEROW 250 (DG31J) B7C

REMARKS

- BOLT-ON ○ LED SHUTTLE BEAM X 2 ○ TIGHTENS WITH STOPPER HOLDER
- VEHICLE SPECIFIC HARNESS, COLLAR, BOLTS incl. ○ ON/OFF SWITCH incl.
- TIE-BAND incl.

※ Be careful not to burn yourself when lighting or after.
※ It might exceed allowable current if device which requires a lot of amount of power such as grip heater is installed at the same time.

COLOR	CODE	PRICE
LIME YELLOW	800-0763030	¥20,500

LED SHUTTLE BEAM KIT



APPLICATION

SEROW 250 (DG31J) B7C

REMARKS

- BOLT-ON ○ LED SHUTTLE BEAM X 2 ○ TIGHTENS WITH STOPPER HOLDER
- VEHICLE SPECIFIC HARNESS, COLLAR, BOLTS incl. ○ ON/OFF SWITCH incl.
- TIE-BAND incl.

※ Be careful not to burn yourself when lighting or after.
※ It might exceed allowable current if device which requires a lot of amount of power such as grip heater is installed at the same time.

COLOR	CODE	PRICE
CLEAR	800-0763080	¥20,000