

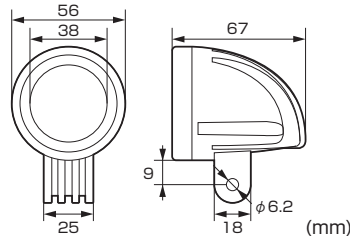

**MONKEY 125 JB03/JB05  
COMES WITH VEHICLE SPECIFIC COUPLER HARNESS!  
NO WIRING MODS REQUIRED!**

**LED SHUTTLE BEAM KIT  
NEWLY RELEASED!!**

High luminosity LED beam lamp with vehicle specific stay and harness. High dress-up effect and visibility when driving at night.



▲ NEW DESIGNED RIM LED SHUTTLE BEAM!

**LED SHUTTLE BEAM**

- BODY : ALUMINUM DIE-CAST BLACK
- LENS : ACRYLIC
- DRIP-PROOF
- BRIGHTNESS : MAX : 800lm (CLEAR)
- COLOR TEMPERATURE : 6,000 K (CLEAR)
- POWER : 10W
- CURRENT : 0.9A



▲ POWER ON/OFF SWITCH  
○ TIGHTENS WITH BRAKE MASTER CYLINDER

**LED SHUTTLE BEAM KIT**



**APPLICATION**

MONKEY 125 (JB03/05)

**REMARKS**

- BOLT-ON ○ LED SHUTTLE BEAM X 2 ○ TIGHTENS ON FRONT FORK STEM LOWER POINT ○ VEHICLE SPECIFIC HARNESS, COLLAR, BOLTS incl.
- ON/OFF SWITCH incl. ○ TIE-BAND incl.

※ Be careful not to burn yourself when lighting or after.  
※ It might exceed allowable current if device which requires a lot of amount of power such as grip heater is installed at the same time.

COLOR	CODE	PRICE
LIME YELLOW	800-1301330 <small>CLICK</small>	¥11,000

※ DOWN FENDER STAY SET (680-1300910 ¥7,000) not usable.

**LED SHUTTLE BEAM KIT**



**APPLICATION**

MONKEY 125 (JB03/05)

**REMARKS**

- BOLT-ON ○ LED SHUTTLE BEAM X 2 ○ TIGHTENS ON FRONT FORK STEM LOWER POINT ○ VEHICLE SPECIFIC HARNESS, COLLAR, BOLTS incl.
- ON/OFF SWITCH incl. ○ TIE-BAND incl.

※ Be careful not to burn yourself when lighting or after.  
※ It might exceed allowable current if device which requires a lot of amount of power such as grip heater is installed at the same time.

COLOR	CODE	PRICE
CLEAR	800-1301380 <small>CLICK</small>	¥9,800

※ DOWN FENDER STAY SET (680-1300910 ¥7,000) not usable.

LIGHT RELATED Dress-up item