



'21~'23 GROM JC92*
COMES WITH VEHICLE SPECIFIC COUPLER HARNESS!
NO WIRING MODS REQUIRED!

**LED SHUTTLE BEAM KIT
NEWLY RELEASED!!
SUPERIOR LED SHUTTLE BEAM POSITIONING!**

High luminosity LED beam lamp with vehicle specific stay and harness. High dress-up effect and visibility when driving at night.



LED SHUTTLE BEAM

- BODY : ALUMINUM DIE-CAST BLACK
- LENS : ACRYLIC
- DRIP-PROOF
- BRIGHTNESS : MAX : 800lm (CLEAR)
- COLOR TEMPERATURE : 6,000 K (CLEAR)
- POWER : 10W
- CURRENT : 0.9A

▲ NEW DESIGNED RIM LED SHUTTLE BEAM !

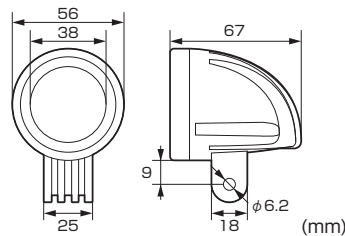

- ▲ POWER ON/OFF SWITCH
- TIGHTENS WITH BRAKE MASTER CYLINDER



LED SHUTTLE BEAM KIT



APPLICATION

GROM (FNo.JC92-1000001 ~ 1199999) ※ FNo.JC92-1200001 ~ not usable

REMARKS

- BOLT-ON ○ LED SHUTTLE BEAM X 2 ○ TIGHTENS ON FRONT FORK STEM LOWER POINT ○ VEHICLE SPECIFIC HARNESS, COLLAR, BOLTS incl.
- ON/OFF SWITCH incl. ○ TIE-BAND incl.

※ Be careful not to burn yourself when lighting or after.

※ It might exceed allowable current if device which requires a lot of amount of power such as grip heater is installed at the same time.

COLOR	CODE	PRICE
LIME YELLOW	800-1452030	¥22,500

LED SHUTTLE BEAM KIT



APPLICATION

GROM (FNo.JC92-1000001 ~ 1199999) ※ FNo.JC92-1200001 ~ not usable

REMARKS

- BOLT-ON ○ LED SHUTTLE BEAM X 2 ○ TIGHTENS ON FRONT FORK STEM LOWER POINT ○ VEHICLE SPECIFIC HARNESS, COLLAR, BOLTS incl.
- ON/OFF SWITCH incl. ○ TIE-BAND incl.

※ Be careful not to burn yourself when lighting or after.

※ It might exceed allowable current if device which requires a lot of amount of power such as grip heater is installed at the same time.

COLOR	CODE	PRICE
CLEAR	800-1452080	¥22,000