

MULTI PURPOSE BAR (PIPE O.D. : $\phi 22.2$)

CODE : 638-1460000

APPLICATION : ADV150 (KF38) / 160 (KF54)

●Thank you for purchasing Kitaco product. Read and understand the instruction before installing.

ATTENTION (MUST READ)

- This instruction sheet is for the instruction for stock condition.
- This product is for dress-up. Do not use for other purposes. Do not modify the way which is not listed or it will cause damage and trouble.
- We are not responsible for violation of law or damages and accidents caused by assembling mistake and improper setting.
- Please ask authorized mechanic for assembling and setting.
- Refer to the manufacturer service manual when installation.
- Bolts and nuts may get loosen by engine vibration. Make sure not to loosen any bolts and nuts before driving.

⚠ ATTENTION!

- Do not hang or apply excessive force to prevent handling. It might cause of break, trouble and accident.
[WEIGHT LIMIT : 500g]
- This product cannot have toughness because of the vehicle structure. Do not apply excessive force as lift or turning vehicle, using rope and tie down.
- Please ride below legal speed. This product is designed for flat road. Do not use for race or bad road riding.

PACKING LIST

FIGURE	NAME	CODE	QTY
1	MULTI PURPOSE BAR	638-1460001	× 1
	END CAP (22.2/BLACK)	998-0900006	× 2
2	SPACER COLLAR $\Phi 13 \times 8.2 \times L20$	093-9000050	× 4
3	FLANGE CAP BOLT M8x50	0900-082-40008	× 4

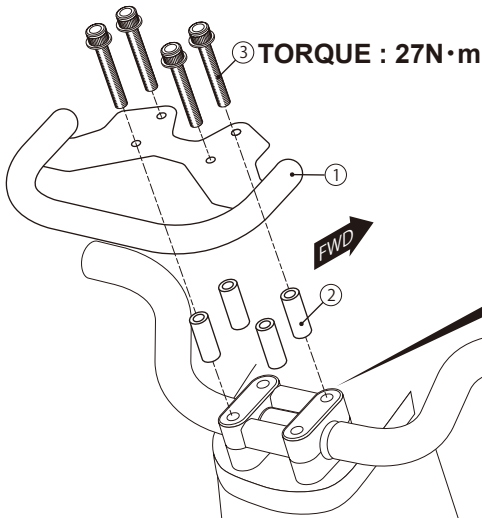

ATTENTION

- ※ Install attached M8 bolt, aluminum collar and upper holder temporarily to multi purpose bar front side hole. Then install to vehicle.
- ※ Install upper holder punch mark to front.
- ※ Tighten bolts from front side 2pcs → back side 2pcs.
- ※ Check each screw tightening and break regularly.

※ Tighten firmly from front side bolt.

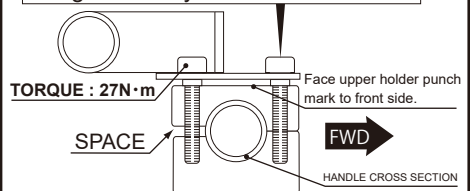

1910 Y-H

 **KITACO**
株式会社 中ノ口

3-8-13 NAGATA,
HIGASHI-OSAKA,
OSAKA, JAPAN