

GROM

Power increase with stock displacement with higher compression!



Stays stock displacement. Higher compression (9.3 : 1 → 12.2 : 1) for high output.

1. PISTON SHAPE

Piston is made from aluminum forged, which has high intensity & heat convertivity.

STOCK PISTON

- ALUMINUM CASTING
- BORE : ϕ 52.4
- COMPRESSION RATIO : 9.3 : 1



HIGH COMP PISTON

- ALUMINUM FORGED
- BORE : ϕ 52.4
- COMPRESSION RATIO : 12.2 : 1



3. HIGH CAMSHAFT type 1 / 2 SPEC.

HIGH CAMSHAFT type 1 : Power increases in the MIDDLE rpm range
HIGH CAMSHAFT type 2 : Power increases in the HIGH rpm range

HIGH OUTPUT expected with high compression piston with high camshaft !!



If you already have i-Map

If you have i-Map GROM Ver. 2.0 or Ver 2.1

Requires : HIGH COMP. PISTON KIT (refer to above) + HIGH CAMSHAFT type 1/2 & HIGH PERFORMANCE EXHAUST (for i-Map)
i-m a p : Map #5 or 6

If you have i-Map GROM Ver. 1.0 (763-1432000)

Requires : HIGH COMP. PISTON KIT (refer to above)+HIGH CAMSHAFT type 1/2 & HIGH PERFORMANCE EXHAUST (for i-Map)
i-m a p : Suitable map is not in it. Please download the map from Kitaco website and write on the user original map.
< DOWNLOAD MAP DATA >
133cc LIGHT BIG BORE KIT X GPR MUFFLER X HIGH CAMSHAFT type 1 or type 2

POWER PACK 125

CAMSHAFT	CODE	PRICE
TYPE-1	355-1432100	¥33,000
TYPE-2	355-1432200	
● FOR RACE USE ● PISTON : ALUMINUM FORGED ● PISTON O.D. : ϕ 52.4 ● COMPRESSION RATIO / 12.2 : 1 (STOCK / 9.3 : 1) ● CAMSHAFT TYPE 1 / 2 AVAILABLE ● i-Map INJECTION CONTROLLER (Ver.2) * HARNESS KIT included. ● HEAD GASKET / BASE GASKET INCLUDED		
APPLICATION	GROM (JC61)	

- * STOCK MUFFLER, STOCK CAMSHAFT NOT USEABLE
- * GPR STAINLESS STEEL UP MUFFLER OR EXTREME R MUFFLER (SOLD SEPARATELY) REQUIRED.
- * NEW SUPER OIL COOLER KIT (FOR CLUTCH COVER KIT) RECOMMENDED. (CLUTCH COVER KIT REQUIRED AS OIL DOES NOT COME FROM STOCK ENGINE)
- * RECOMMENDED ENGINE OIL :
elf MOTO4 PRO TECH 5W-40 (1L : 968-2000021 ¥2,800)
PANOLIN STREET 4T RACE 10W/50 (1L : 968-2996001 ¥3,300) **NEW**

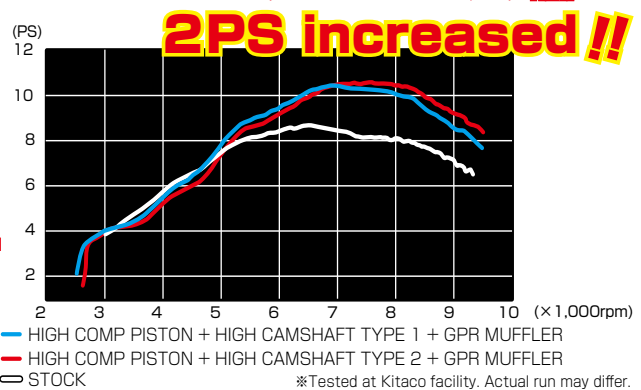

2. Easy installation of i-Map (GROM Ver. 2) without wiring mods.

Just connect the harness kit

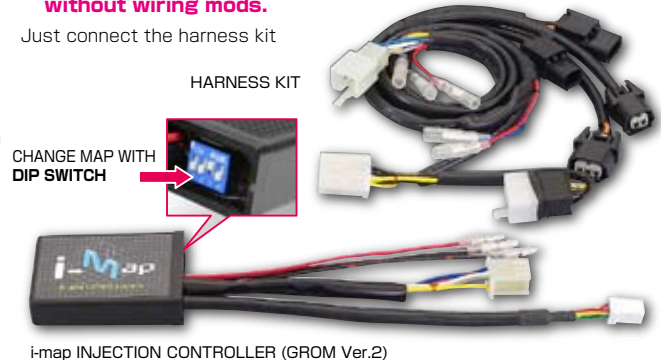

HIGH COMP. PISTON KIT

CODE	PRICE
350-1432200	¥ 12,000
● POWER PACK 125 OPTION PARTS ● PISTON : ALUMINUM FORGED ● PISTON O.D. : ϕ 52.4 ● COMPRESSION RATIO : 12.2 : 1 (STOCK 9.3 : 1) ● HEAD GASKET / BASE GASKET INCLUDED. ● PREMIUM GASOLINE TYPE	
APPLICATION	GROM (JC61)

